

# Spectrum 1313-4-SPH

Class I Division 2- UL Listed Industrial Control Panel

## Features

- IEEE 802.3at PoE+ to supply 30 watts per port
- Supports IEEE 802.3af
- Supports dual speed for SFP slot
- Link pass through
- Operating Temperature -25°C to +40°C
- Class I
- Division 2
- Groups B, C, D
- Full/half-duplex flow control
- Auto-MDI/MDIX
- Auto-Negotiation
- Store-and-forward transmission
- 10K byte jumbo frames



## Description

Spectrum 1313-4-SPH is a UL listed industrial control panel, hazardous-area certified for Class I, Division 2, groups B,C,D T4. The control panels allows for injection of up to (4) 30W PoE+ devieces - \*note: SFP module not supplied. The ruggedized switch is perfect for challenging environments when mounted inside a surveillance cabinet. It is designed to withstand shock, vibrations and temperatures from -25°C to +40°C (-13°F to +104°F), making it perfect for high demanding installations.

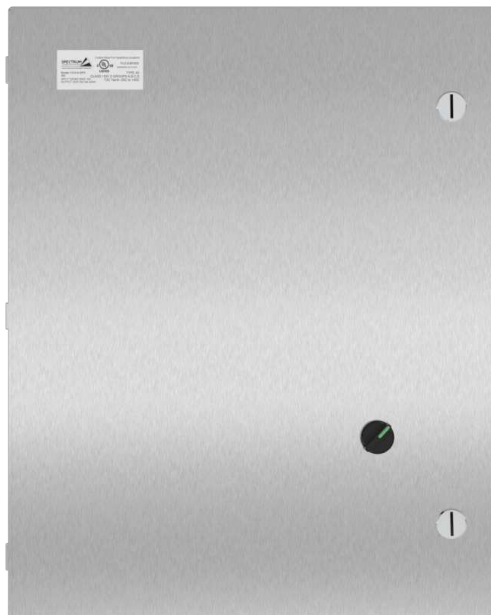

# Specifications

## Spectrum 1313-4-SPH

### General

Dimensions	406.4 x 508 x 225.425 mm ( 16 x 20 x 8.875 in. )
Weight	19.05 kg ( 42 lbs )
Material	316 Stainless Steel
Operating Conditions	-25°C to +40°C
Storage Conditions	-40°C to +85°C
UL Listed File Number	E481600
Input	120VAC 60HZ 10A
Output	IEEE 802.3at 60W
Power consumption	3.53 Watts (No PoE) 63.5 Watts (2 ports PoE)
Status LEDs	Copper Port: Link/ACT Copper Port: Gigabit Transmission SFP Port: Link/ACT PoE Power Input Power
Explosion-proof Certifications	Class I Division 2 Groups B,C,D
Certifications	CE Mark, FCC Class A, EN55011, EN55022/EN61000-6-4 (EMC), EN55024/EN61000-6-2 (Immunity), EN61000-4-2 (ESD), EN61000-4-3 (RS), EN61000-4-4 (EFT), EN61000-4-5 (Surge), EN61000-4-6(CS) EN61000-4-8 (Magnetic Field), IEC60068-2-27(Shock), IEC60068-2-32 (Free fall), IEC60068-2-6 (Vibration)
Standards	IEEE 802.3 IEEE 802.3x IEEE 802.3u IEEE 802.3ab IEEE 802.3at IEEE 802.3z IEEE 802.3af
Warranty	3-year limited warranty, see <a href="http://spectrumcamera.com/warranty">spectrumcamera.com/warranty</a>

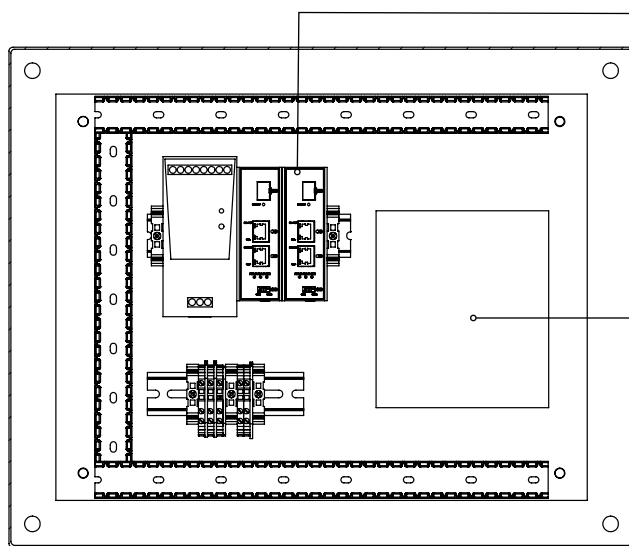

**Customer Supplied SFP Module**

**Customer Supplied CCH**

Single-panel, wall-mount housing; accepts 1 CCH connector panel; also includes a 6-slot, 0.4-in splice holder and be used for splice management, cross-connect or both up to 12 fibers; CCH panels ordered separately.

# Approvals

Control Panel For Hazardous Locations

**SPECTRUM**  
CAMERA SOLUTIONS  
SPECIALIZING IN EXPLOSION PROOF TECHNOLOGY

**cULus**  
**LISTED**

FILE: E481600  
DRAWING# 1313-4-SPH

Model: 1313-4-SPH  
SN:  
INPUT: 120VAC 60HZ 10A  
OUTPUT: IEEE 802.3at 60W

TYPE 4X  
CLASS I DIV 2 GROUPS B,C,D  
T4 Tamb -25C to +40C