

The MODEX series includes a temperature measuring transducer mounted on-site in the same way as a rail-mounted terminal. The module transforms the signal received from the Pt100 temperature sensor into a proportional, load-independent 4 to 20 mA output signal. The sensor circuit is intrinsically safe according to Ex protection type Ex ia. An output current exceeding the 4 to 20 mA range signals a sensor fault (open/short circuit). The Pt100 temperature sensor can be operated in 2-wire or 3-wire circuits in Zone 0 or Zone 1.

Explosion protection

Marking ATEX	II 2G Ex db e IIC Gb II M2 Ex db e I Mb
Certification	PTB 97 ATEX 1068 U TÜV 97 ATEX 1204 X
Marking IECEx	Ex db e [Ia Ga] IIC/IIB Gb Ex db e [Ia Ma] I Mb
Certification	IECEx PTB 11.0083U IECEx TUN 11.0030X
Marking CSA	Class I, Zone 1, IIC A/Ex d e [Ia] IIC Gb
Certification	CSA 2011-2484303U
Other approvals and certificates, see www.bartec.de	
Fitting	Pt100 measuring transducer Type 17-6582-1.../.... II (1)G [Ex ia Ga] IIC/IIB II (1)D [Ex ia Da] IIC/IIB

Safety data

$U_m = 253 \text{ V}$
 $I_o = 12 \text{ mA}$
 $U_o = 17.3 \text{ V}$
 $P = 51.9 \text{ mW}$

Ex ia	IIC	IIB
$L_o \text{ (mH)} \leq$	200	800
$C_o \text{ (nF)} \leq$	341	2048

Technical data

Enclosure material	High-quality thermoplastic
Protection class	Module IP 66 EN/IEC 60529 Terminals IP 20 EN/IEC 60529
Terminals	2.5 mm ² , fine stranded
Mounting rail	TH 35 x 7.5 (15) EN/IEC 60715
Terminal designation	written marking labels
Ambient temperature	-40 °C to +60 °C at T4
Storage temperature	-40 °C to +60 °C
Weight	0.250 kg

Electrical data

Operating voltage	DC 24 V -10 %, +20 %
Power consumption	1.6 W
Sensor	Pt100 temperature sensor 2- or 3-wire circuits
Output	Load independent current: 4 to 20 mA Max. load: $\leq 400 \Omega$
Temperature range	-50 °C to +100 °C 0 °C to +200 °C 0 °C to +400 °C
Accuracy	$\pm 1 \%$ of upper value
Function test	Connect 100 Ω resistance to terminal 15 - 16 and bridge terminals 16 and 17. Apply current between L- and terminal 31. Note: Observe terminal assignment.

Ordering information

-50 °C to +100 °C	07-7311-93T5/5350
0 °C to +200 °C	07-7311-93T5/7350
0 °C to +400 °C	07-7311-93T5/9350
0 °C to +150 °C	07-7311-93T5/A350

Technical data subject to change without notice.

Dimensions/mounting positions

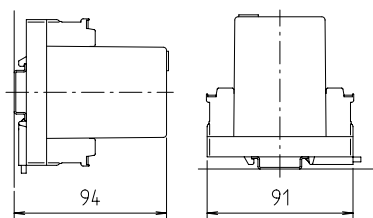

Module width: 30 mm

Wiring diagram/terminal assignment

