



## SmartPlug R Quick Start Guide



### WEARING THE HEADSET

smartPlug R is a state of the art hearing protection communication system that allows you to retain situational awareness while remaining in full contact with your two-way radio communication device.

Situational awareness is provided by SENS<sup>®</sup> processing technology and environmental microphones mounted within the earbuds.

The smartPlug R headset draws power from the two-way radio. It must be connected by the appropriate SRCK7(XXX) radio cable to utilize both SENS<sup>®</sup> situational awareness and two-way radio communication.

SRCK7(XXX) part numbers vary depending on the radio connector and are sold separately. For language translated manuals and further information please visit [www.sensear.com](http://www.sensear.com).



The smartPlug R is designed to be worn with the main housing attaching to the belt or pant seam, and the Inline PTT attaching to the shirt / upper garment of the user.

### FITTING THE EARBUDS

The smartPlug R comes with a detachable ear piece assembly designed for ease of serviceability and hygiene for users who share the base unit. For further information and to order additional ear piece assemblies, please contact your supplier or visit [www.sensear.com](http://www.sensear.com)

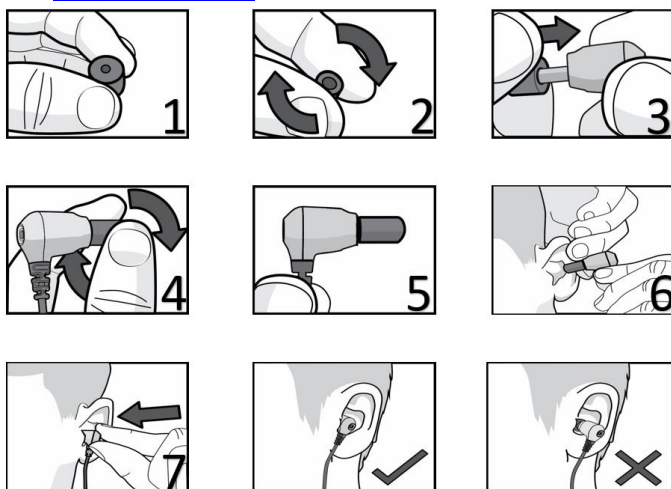

1. Place disposable foam tip between thumb and forefinger.
2. Roll foam tip to a compressed, crease free cylinder.
3. Push the foam tip all the way onto the ear bud spout.
4. Roll the foam tip again between the thumb and forefinger.
5. Ensure the foam tip remains a compressed crease-free cylinder.
6. Using your opposite hand, pull your ear upward & outward.
7. Insert the earbud and hold in place for 30 seconds while the foam tip expands. Proper fit is ensured by not having any of the foam tip visible while the earbud is in the ear.

### OPERATING THE HEADSET

#### POWER ON:

1. Connect the SRCK7XXX radio cable to the Hirose connector on the bottom of the main unit.
2. Connect the SRCK7XXX cable to the two-way radio.
3. Turn the two-way radio on.
4. The headset will power up. An audible "Sensear, sounds good to me" will be heard through the headset.

#### POWER OFF:

- Option 1. Turn the two-way radio off from the two-way radio.  
 Option 2. Disconnect the headset cable from the SRCK7XXX cable.  
 (Option 2. Reverts audio back to the two-way radio automatically)

### ENVIRONMENTAL MODES

#### SENS<sup>®</sup> MODE:

Upon power-up the headset is in SENS<sup>®</sup> mode by default. A quick press of the power button will toggle the unit into quiet mode. This allows for easy muting of Sensear's situational awareness feature when and if this is preferred by the user. Another quick press will reactivate SENS<sup>®</sup> mode.

### COMMUNICATING OVER TWO-WAY RADIO

- Press and hold the button located smartPlug R's built-in PTT.
- Release the inline PTT button to cease transmission.
- Radio volume is controlled on the two-way radio